





# 102 Rakewood Drive, Moorside

£369,950

🛏️ 4 🚿 2 🚗 2



- No Chain
- Extended Detached Family Home
- Lovely Condition
- Large Plot & Double Garage
- Four Bedrooms
- Two Bathrooms
- Awesome Kitchen/Living Space
- EPC: D







What a lovely house this one is! A superb four bedroom extended property located in this tucked away cul de sac in Moorside, close to Saddleworth.

Accommodation comprising: Entrance hallway, lounge, large kitchen with open plan dining/living room and a bathroom. To the first floor are four good size bedrooms and a shower room.

Externally the property sits on a large corner plot, double garage and a large four car driveway.

This super house offers NO CHAIN and therefore viewing is highly recommended.

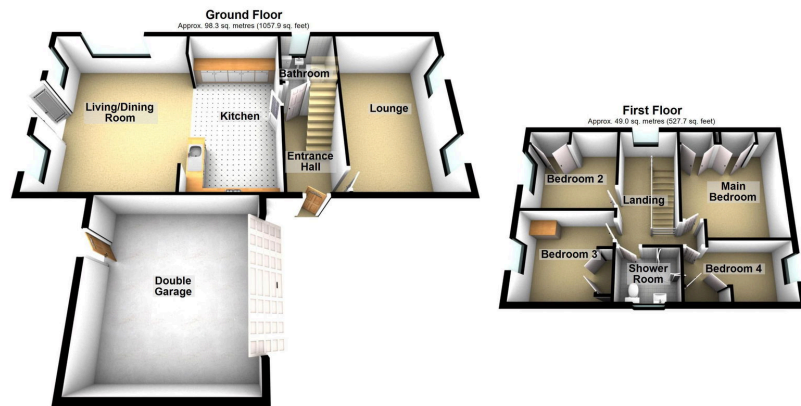

Total area: approx. 147.3 sq. metres (1585.6 sq. feet)

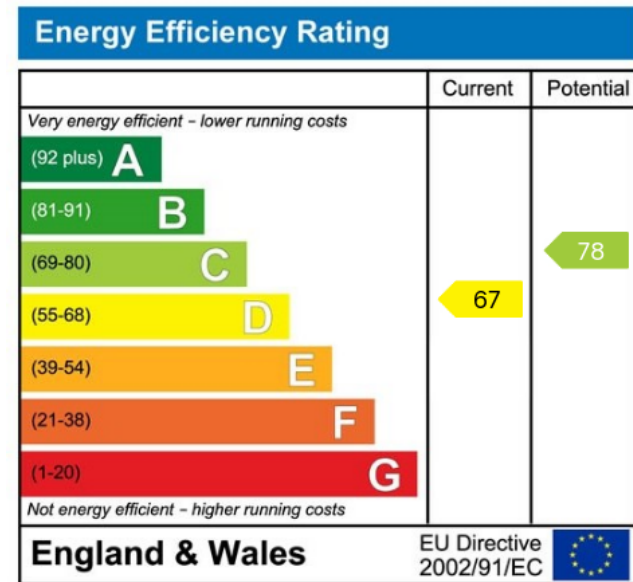

**Chadderton Office**

509 Middleton Road,  
Chadderton, Oldham,  
OL9 9SH

chadderton@kirkham-property.co.uk  
t: 0161 626 5688